

AUTOMATIC BOLLARD SERIES

PRODUCTION TECHNOLOGY GUIDE BOOK

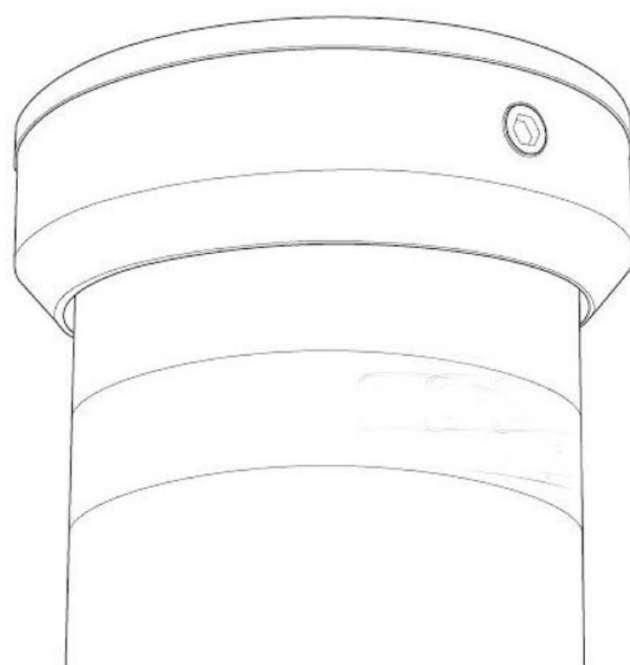

Thank for choosing safe, comfortable, reliable, cncame automatic bollard, this product belongs to the technical equipment,before you use this product,please read this book carefully.

If you have any problems during the installation,please contact with customer service department.



To make the installation and operation successful, please kindly read the guide book, all the installation and operation should be according to the safety rules by the related technical personnel.

A: Retractable part

Fust is lifting vertical to the ground.

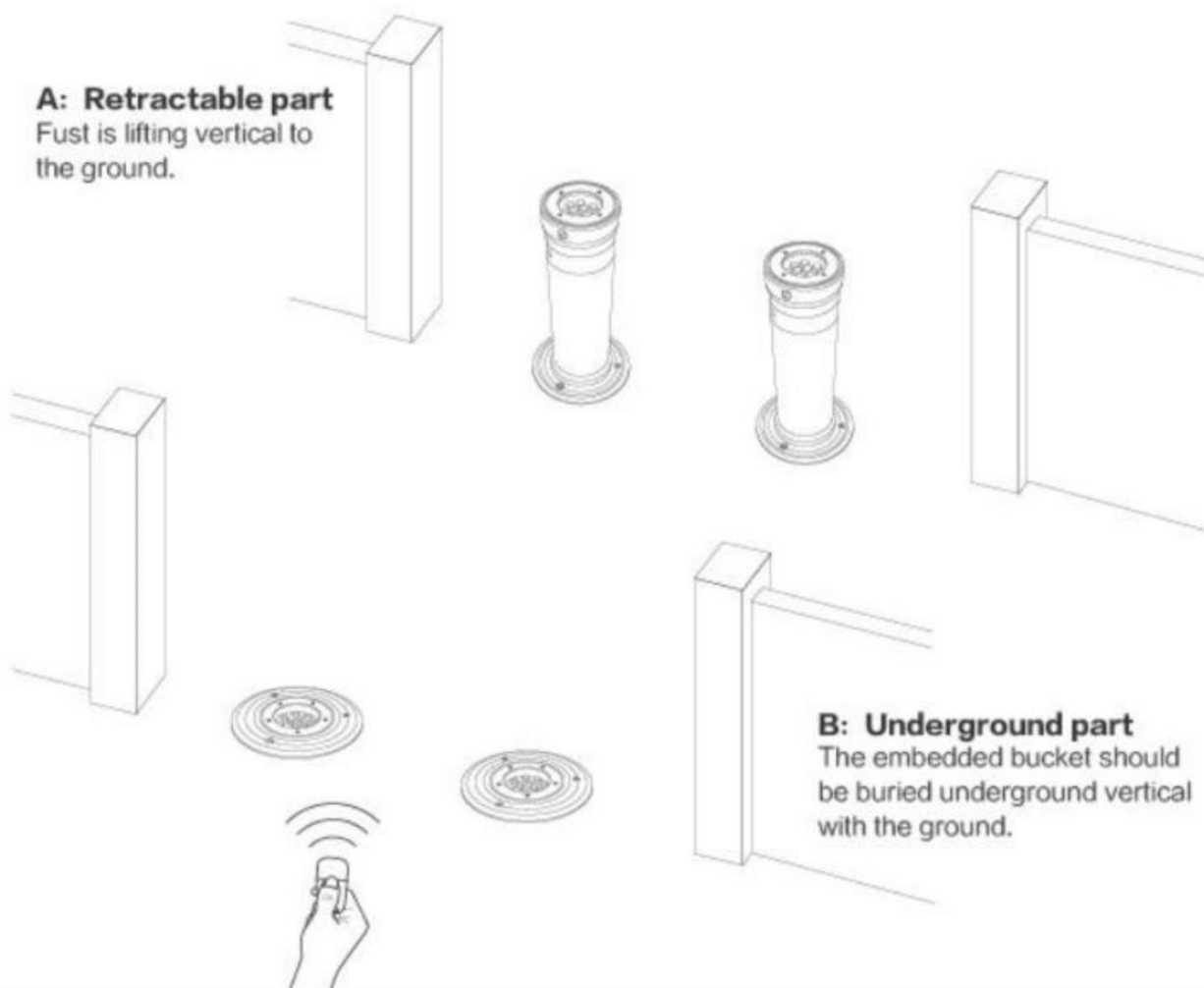

B: Underground part

The embedded bucket should be buried underground vertical with the ground.

ACCESSORY

Please Kindly Keep The Specification For The Future.cncame Bollard With The Following Parts.

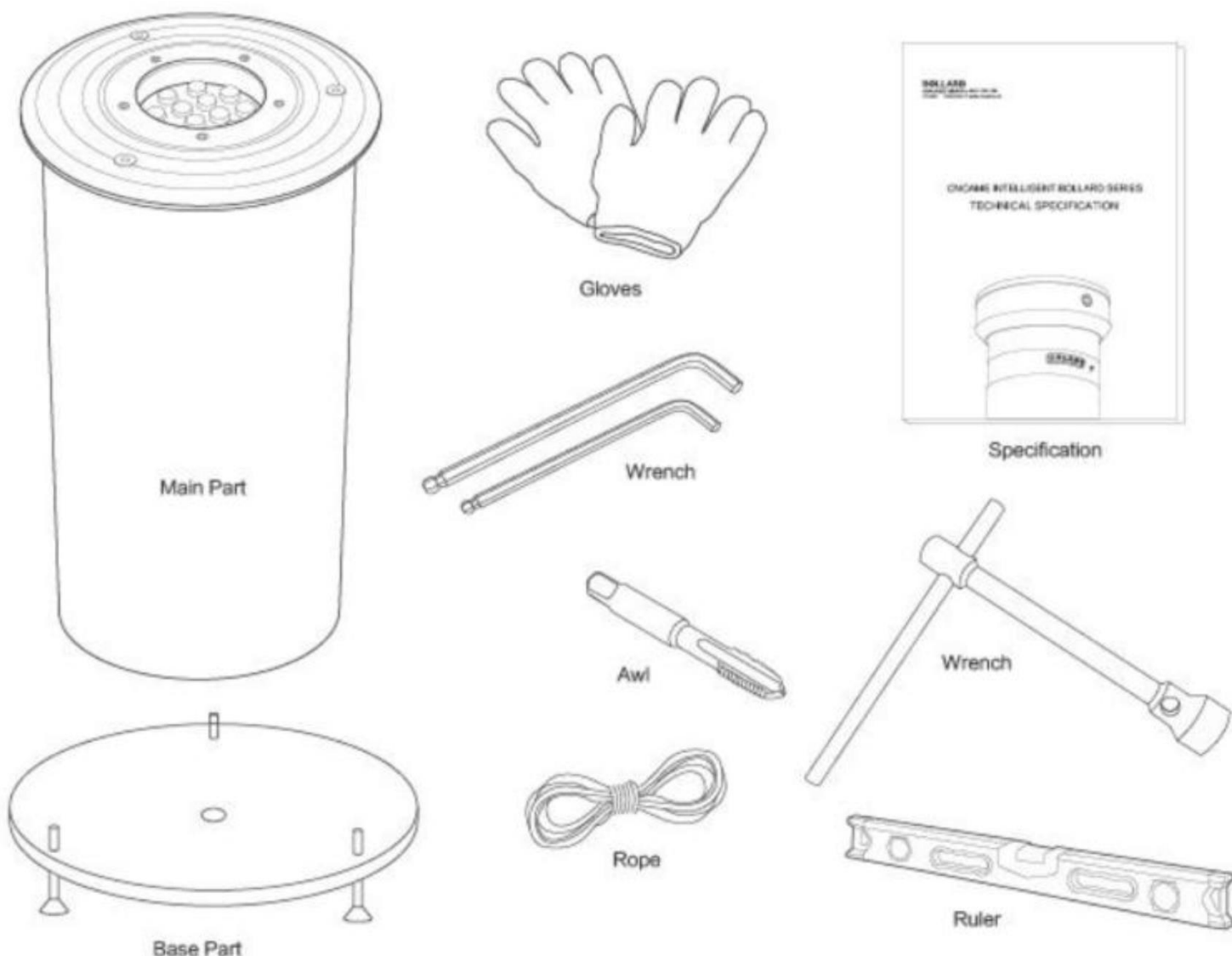

OVERVIEW

- ① Our products can be installed simple,the parameter of bollard can be regulated by itself
- ② The material of cncame intelligent bollard is 316 stainless steel.
- ③ Once the embedded bucket fixed,the operator can install and regulate the bollard quickly.Even the embedded bucket arises deviation,also you can make the retractable fust to lift vertical by regulation.
- ④ Product can be controlled by the wireless transmitter instruction or manual button by using intelligent control program,the operator can configure any pass access system(computer software control,mobile phone card,long distance card,license plate recognition and so on)
- ⑤ The reflective tape of fust is clearly visible in the night.
- ⑥ A variety of fust colors and led warning light(optional)



Please remember the following rules before construction

- ① Before digging embedded foundation, Please make sure the municipal public facilities and underground pipelines
- ② Please do not affect the normal installation.
- ③ Confirm the embedded location of the underground soil material
- ④ Remove all around obstacles
- ⑤ The construction must be Surrounded by the cordon .

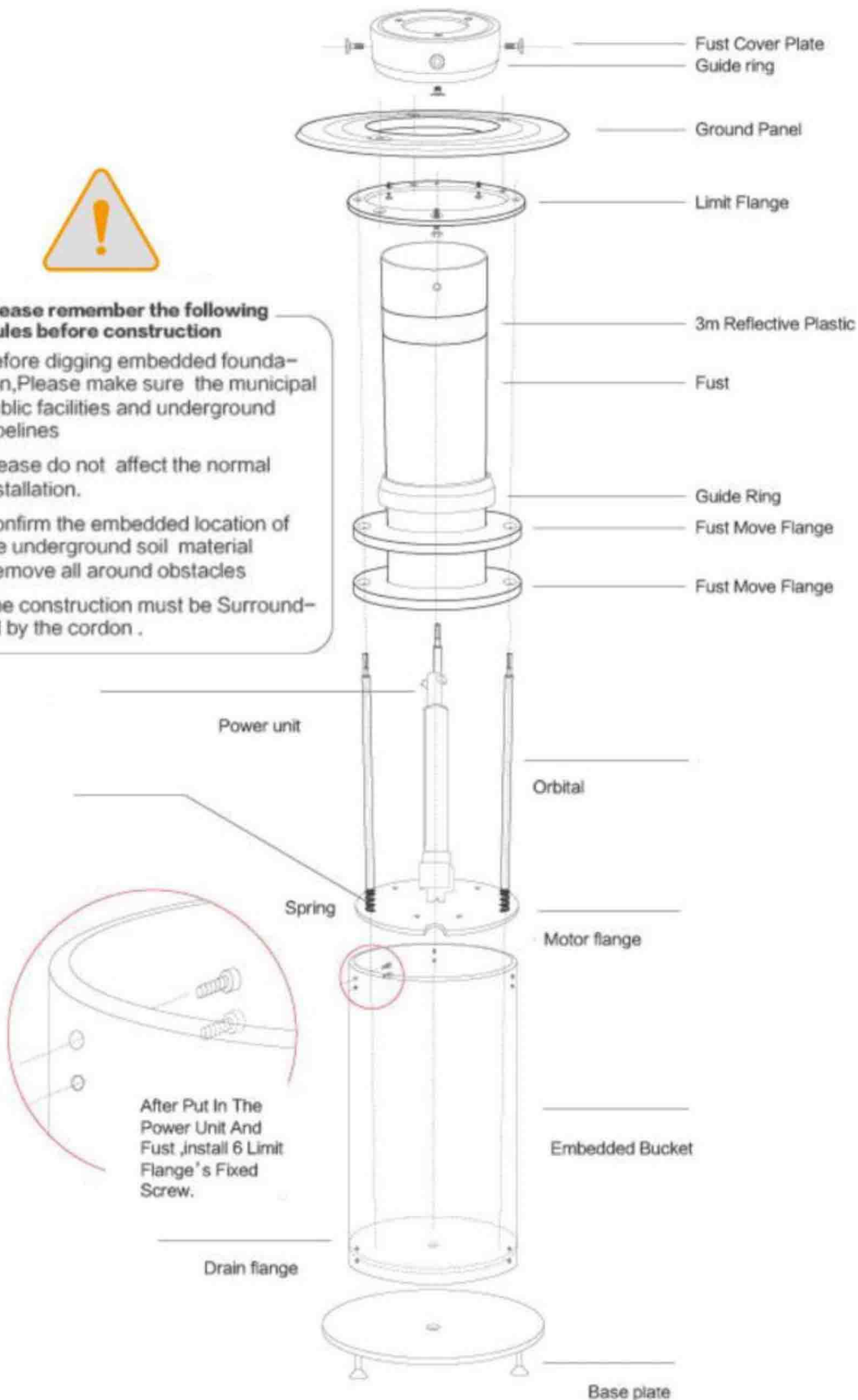



When you dismount the host engine, you need dismount the hexagonal screw inside.

When you 're Installing the embedded bucket, pumping concrete, need to install the hexagonal screw inside. To prevent the concrete into the stuffed with screw holes.

First remove the bollard surface panel, and dismount to single parts, take out the fust (take care of the fust surface) and Hydraulic power unit.

When you are Improving the power unit, please do not break or tear the cable.

EMBEDDED FOUNDATION EXCAVATION

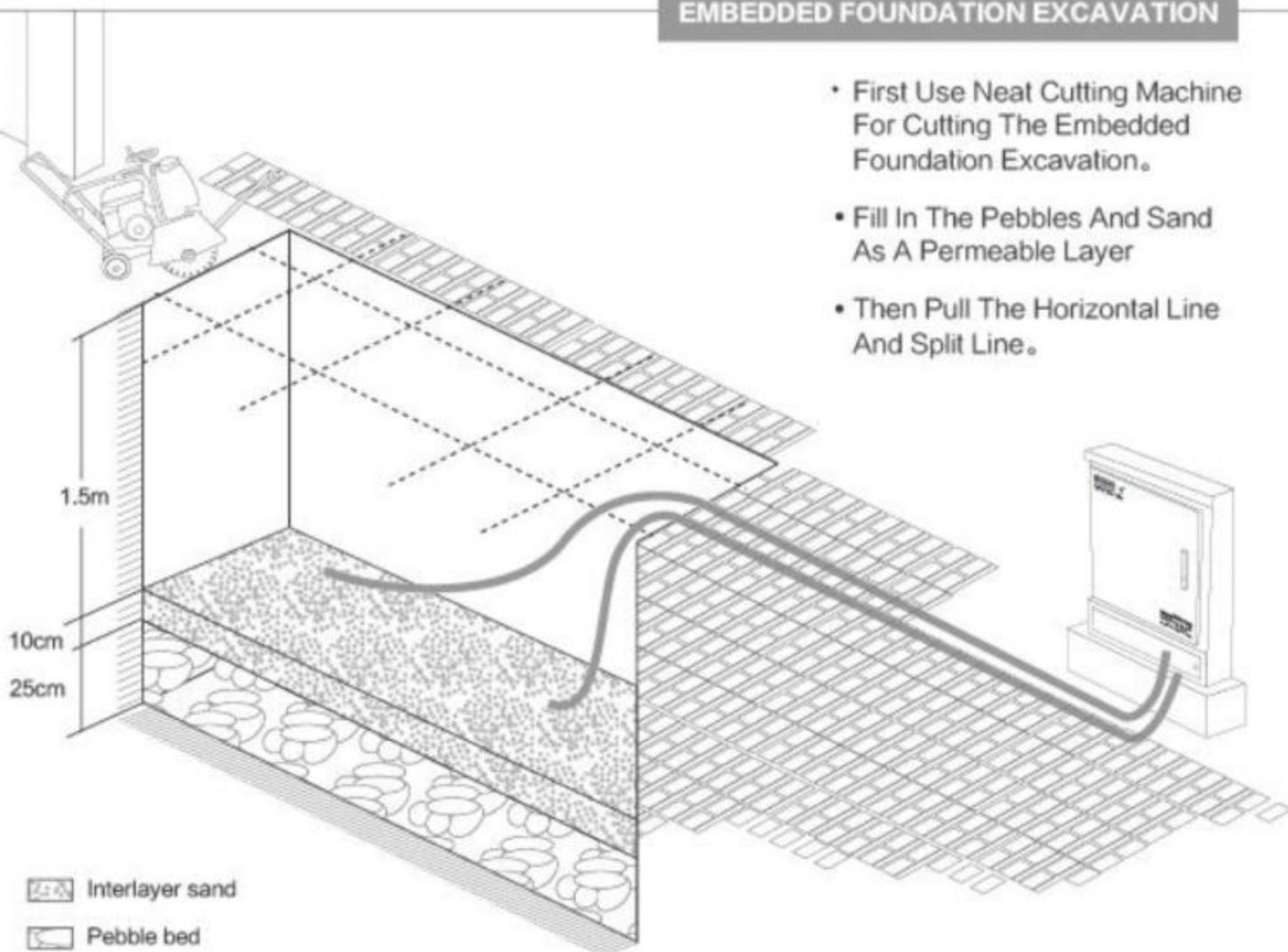

THE INSTALLATION OF EMBEDDED BUCKET

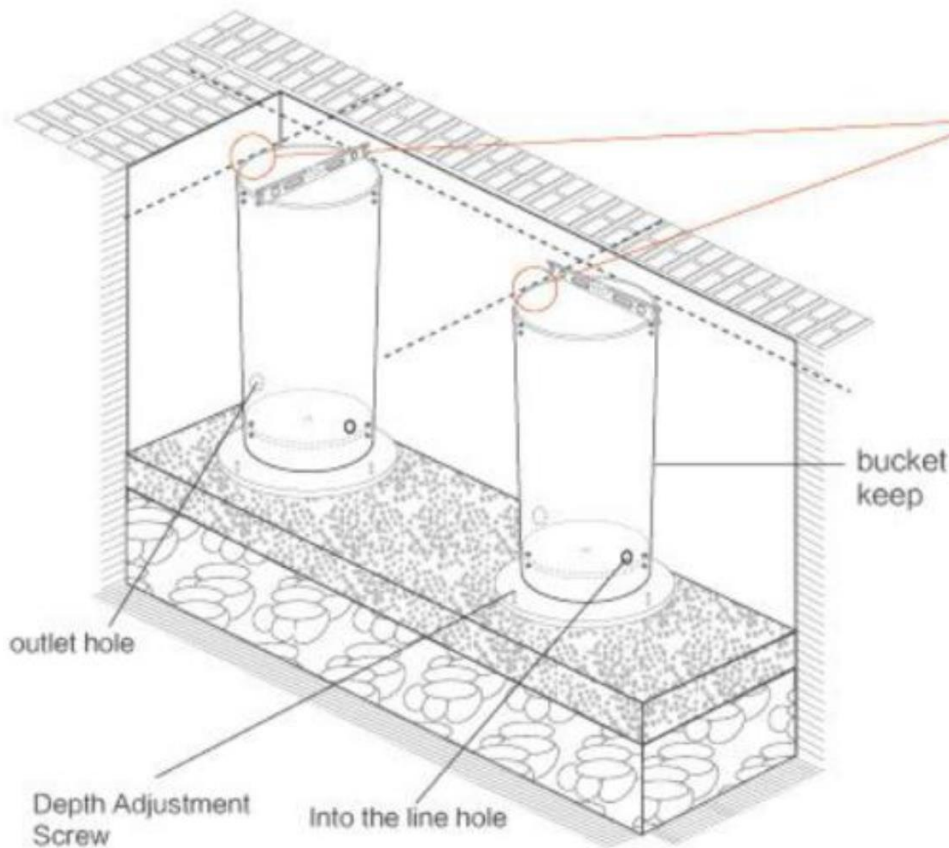

It is important that the installation of embedded bucket. Keep the level with the ground

- While installing the embedded bucket keep their level with the ground
- While installing the embedded bucket keep them align in average
- Keep the cable to the power port
- While in the high water level situation. Connect the drain-pipe to the drainage channel.

PREPARATION OF THE CONCRETING

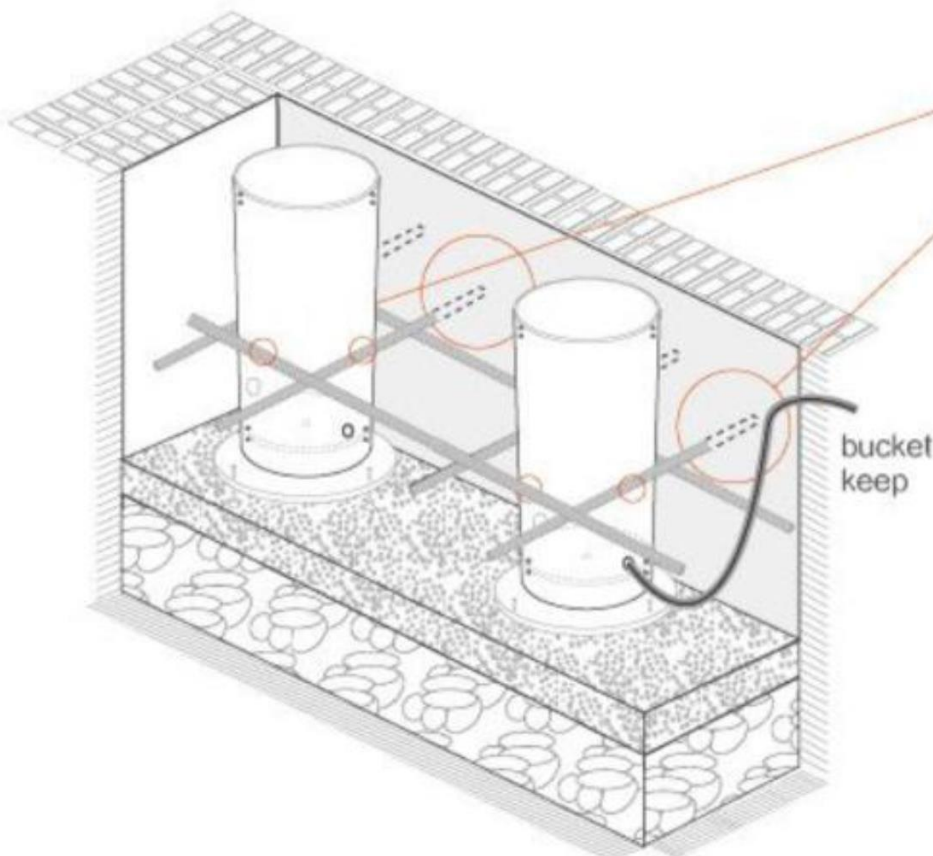

The part of rebar with bucket need to weld

The rebar must be firmly insert to the side-wall

- Before concreting keep the top of the bucket level with ground
- Keep the pipeline unimpeded
- The power line go through the embedded bucket and remain at least 1.5m
- Keep the power line in protection
- Connect all the cables

POURING CONCRETE

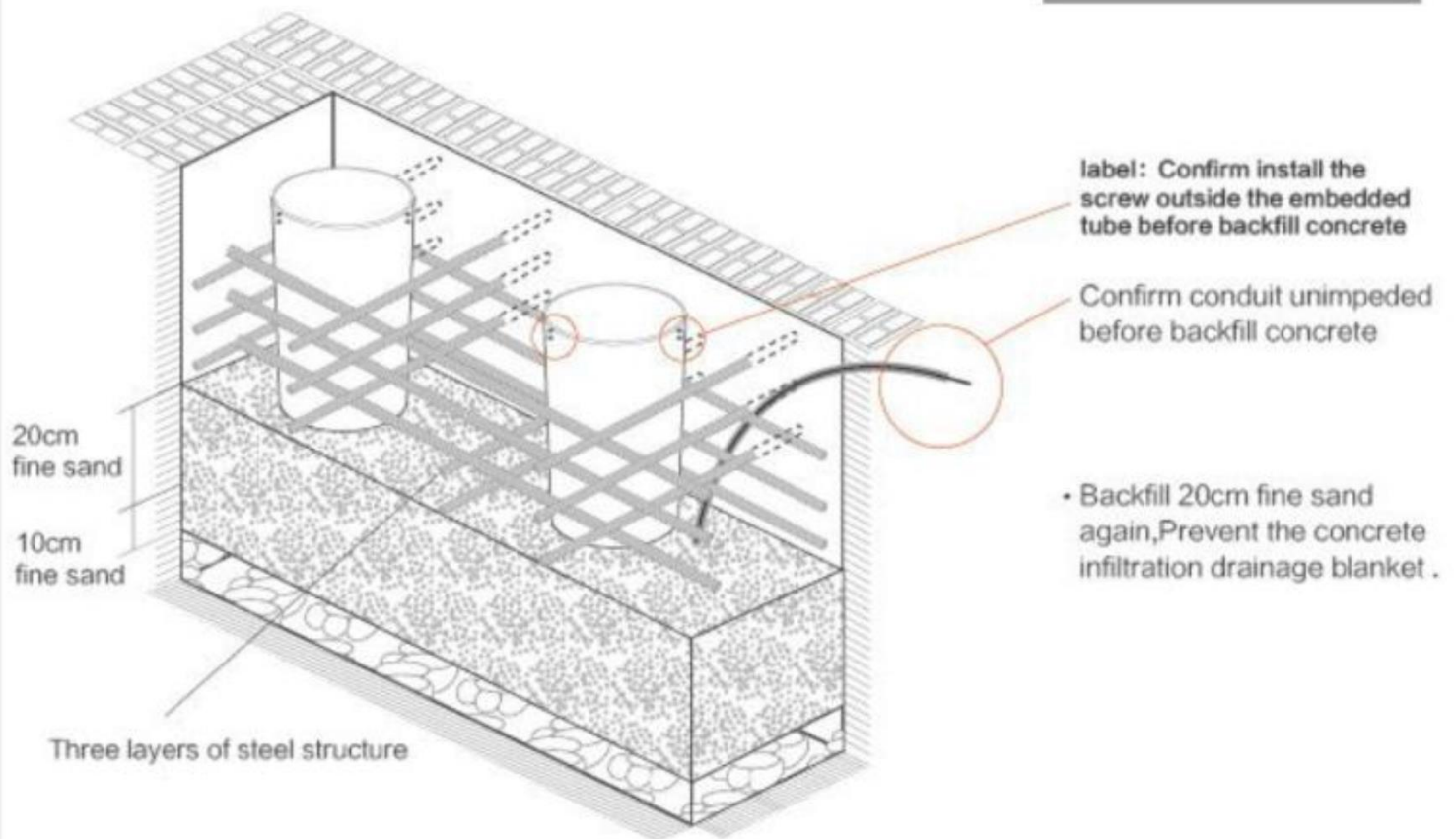

POURING CONCRETE. INSTALL LIMIT FLANGE

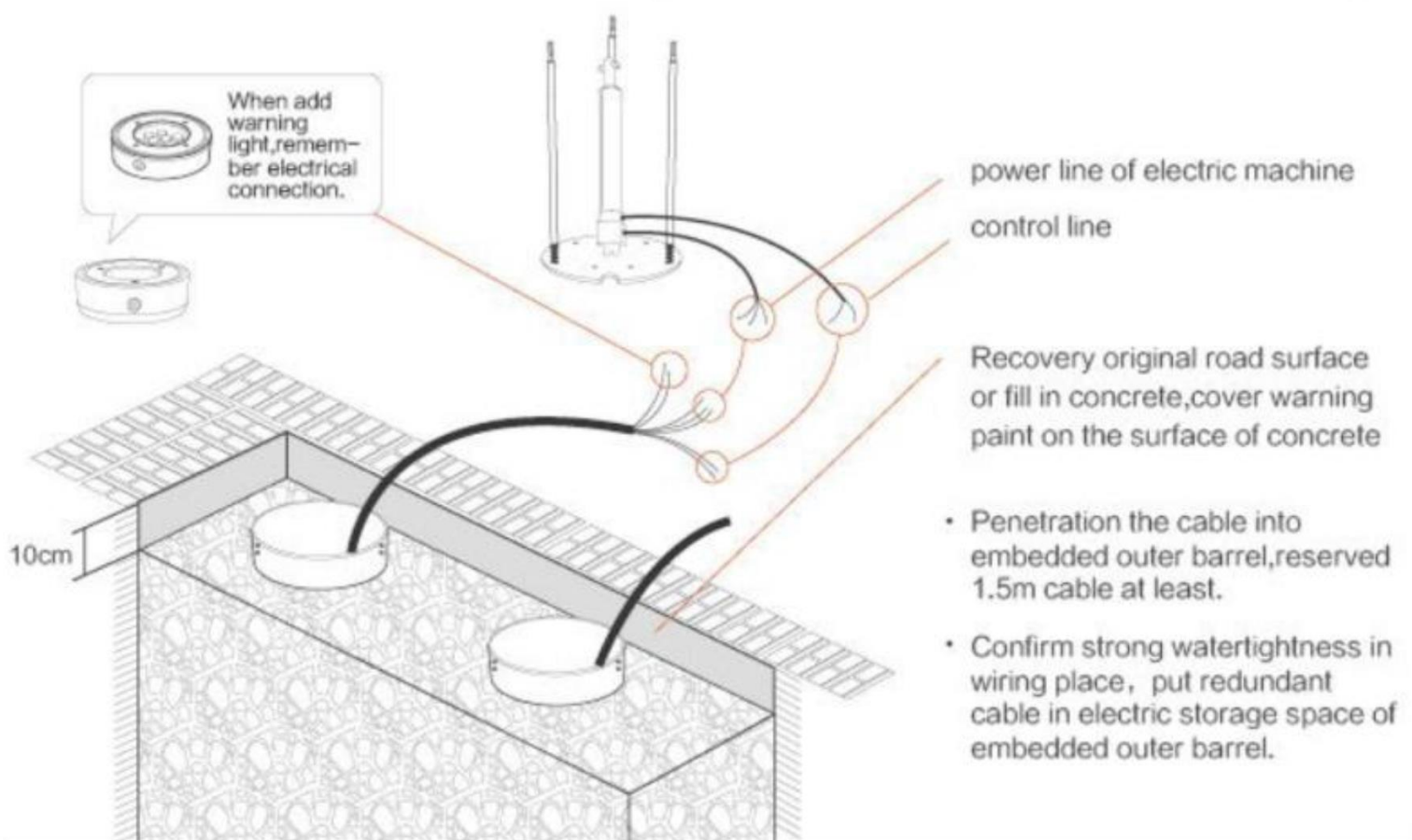

Use socket wrench to adjust electrical machine in the centre of Embedded tube.

Label:when bracket for motor go down,Please put the motor plate gap to access line, if the environment is high water level, it is need connect drain-pipe to the ditch nearby

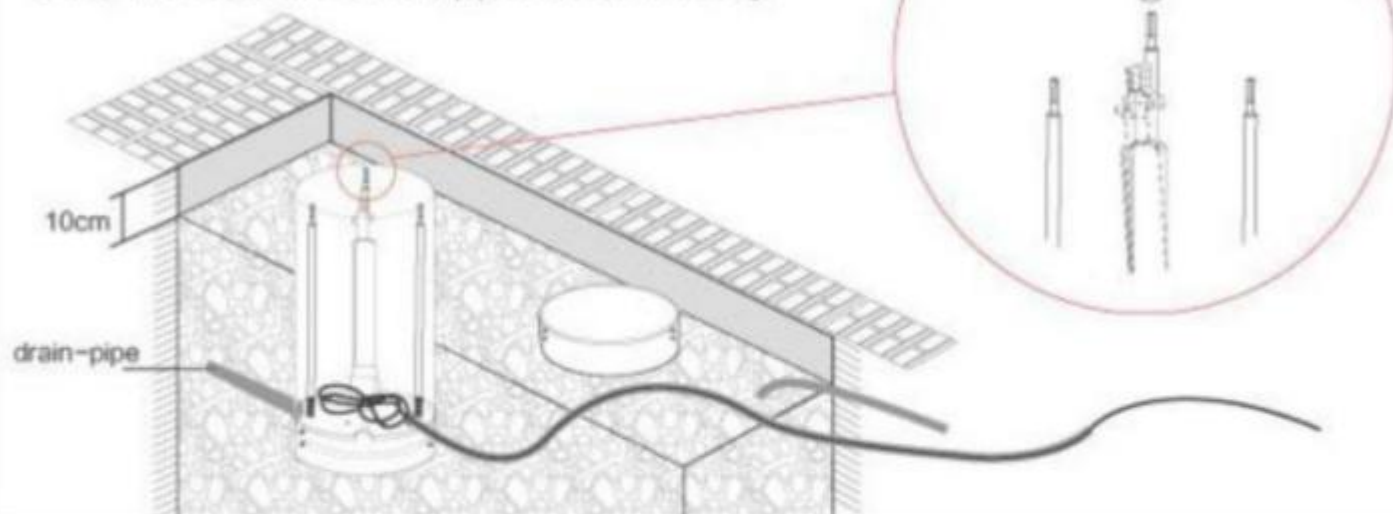

INSTALLATION FUST

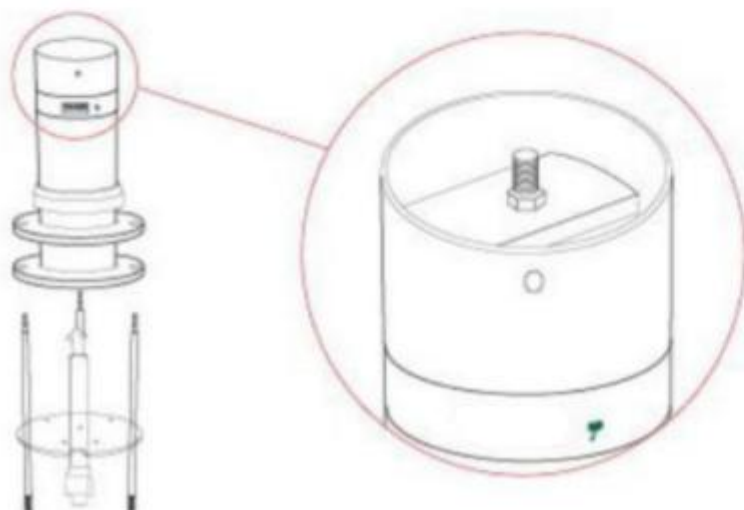

- When installation fust,must notice the surface of the fust;
- you can adjust the altitude through fust fixation screw



Accommodation

- Fix Limit Flange Through Screw;
- Use Socket Wrench To Adjust Fust Concentric Coaxial;
- Prepare Energizing,debugging Bollards.

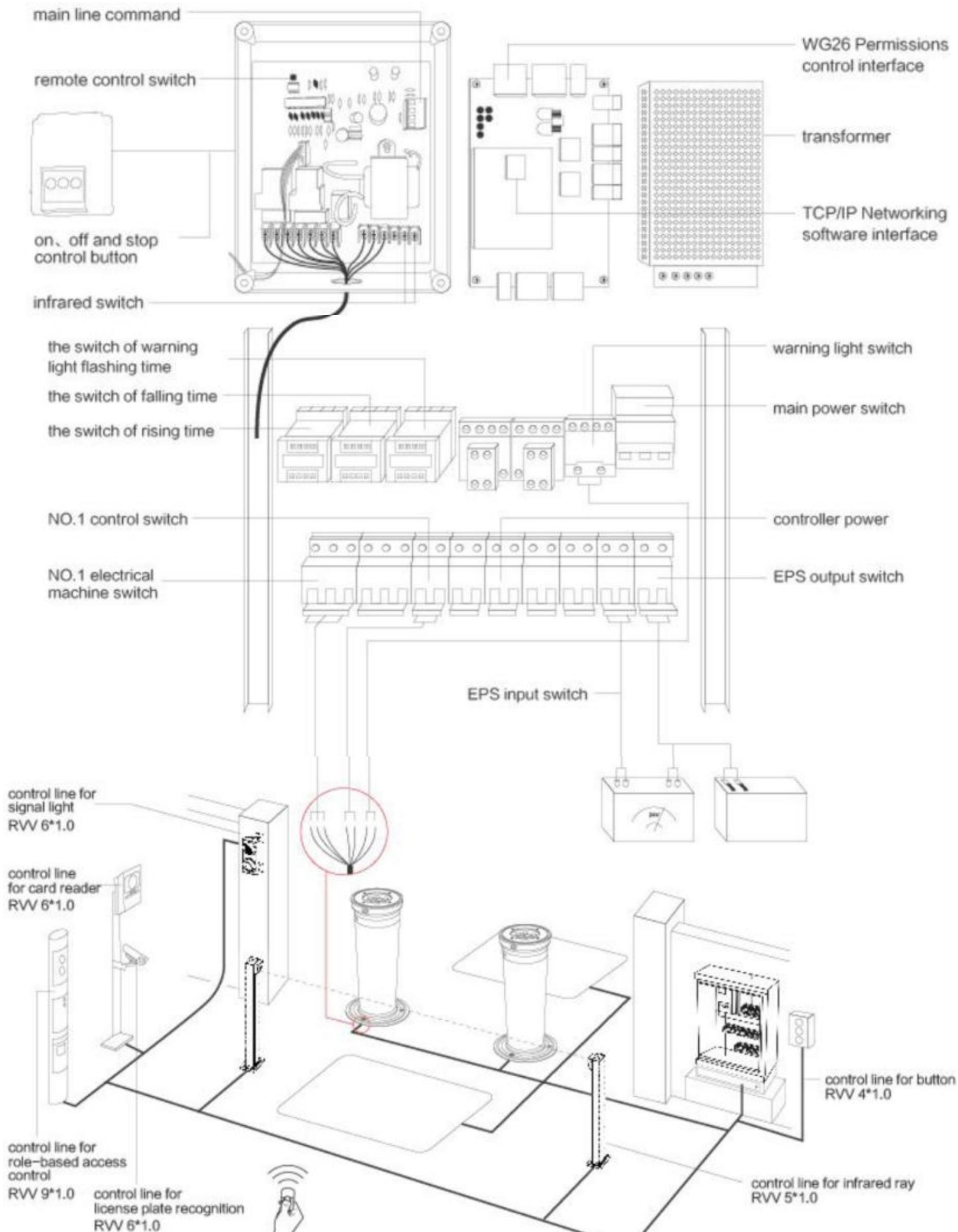

The way to install semi-automatic bollard is as same as electromechanical bollard

ANGLE ADJUSTMENT

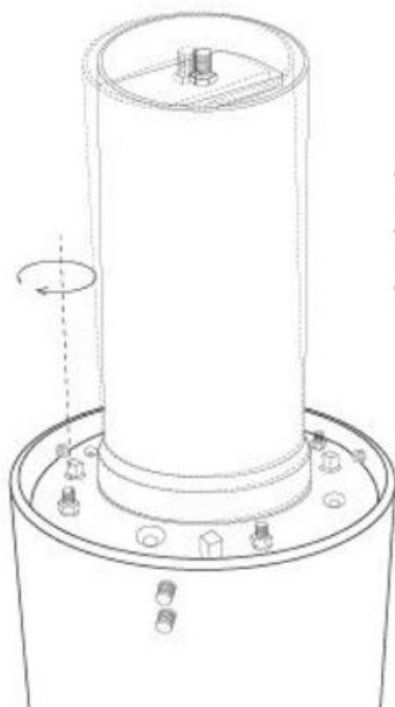

- when the bollard rising, you can adjust the angle through limit screw;
- after rising limit and adjust the limiting, fastening the NUT;
- please adjust the three limit screw to contact the process flange.

